

FOR LEASE

1840 – A Waterville Road

Macon, Georgia



Lease Price:
\$1.50 psf gross



Property: 42,326 sf Warehouse building that can be divided (10,857 and 31,469 sf)

Location: Located in Macon's Downtown Industrial Park with good access to Macon's Central Business District

Ceilings: 18 to 25'

Dock Doors: Four

Ground Level Door: One

Zoning: Industrial

Parking: Ample in shared yard

Sprinklered: No



Contact:
Larry Crumbley CCIM, SIOR, CRE, CPM
478-746-9421
See detailed property information at
www.Fickling.com

Commercial Division
577 Mulberry Street
P.O. Box 310
Macon, GA 31202
(478) 746-9421
(478) 742-2015 FAX
info@fickling.com EMAIL

www.fickling.com

FOR LEASE

1840 – A Waterville Road Macon, Georgia

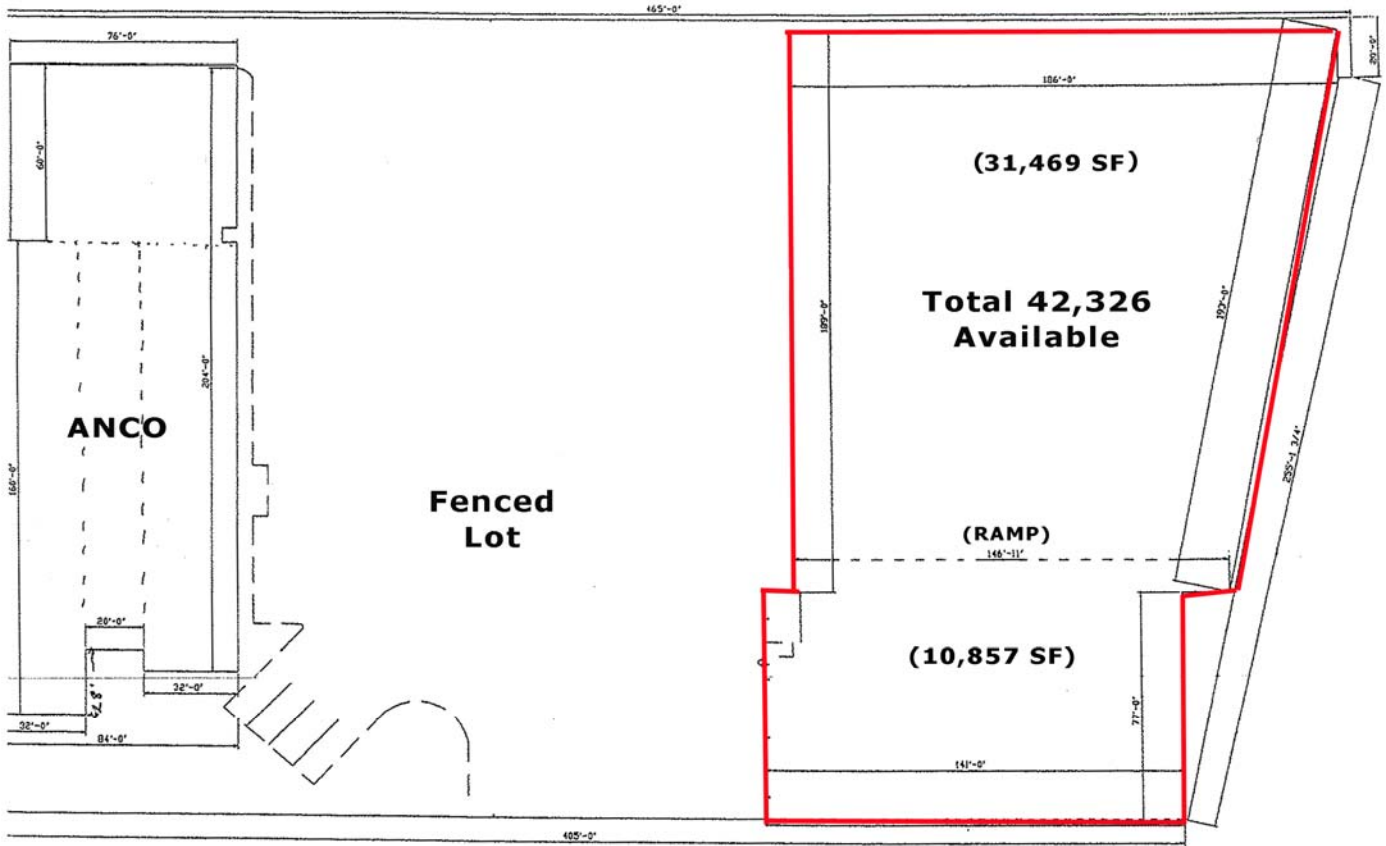

This information is from resources deemed to be reliable, no warranties or guarantees for accuracy are made by Fickling and Company